

# NOTICE OF STUDY COMMENCEMENT

## Municipal Class Environmental Assessment

### Regional Road 107 (Bovaird Drive) from Lake Louise Drive/Worthington Avenue to 1.45km west of Heritage Road

#### The Study

The Regional Municipality of Peel has initiated a Municipal Class Environmental Assessment for improvements to Bovaird Drive from Lake Louise Drive/Worthington Avenue to 1.45km west of Heritage Road. The approximate limits of the project area are illustrated on the key plan. The Region of Peel in conjunction with Halton Region, Town of Caledon, City of Brampton and Town of Halton Hills is undertaking the Halton Peel Boundary Area Transportation Study (HPBATS) which is expected to be completed in 2010. The west study limit of the Bovaird Drive EA may be reviewed based on the recommendations of HPBATS and the project scope revised accordingly.

The study will examine the need and feasibility for widening and improvements on Bovaird Drive to address short term and long term issues related to planned future growth, operational, geometric, capacity and storm drainage deficiencies.

#### The Process

The study is being conducted in accordance with the requirements for a Schedule "C" project as described in the Municipal Engineers Association's Municipal Class Environmental Assessment (EA) document (October 2000, as amended in 2007), which is approved under the *Ontario Environmental Assessment Act*. The Class EA process will include public and agency consultation, an evaluation of road improvement alternatives, an assessment of the potential environmental effects of the proposed improvements and identification of reasonable measures to mitigate any adverse impacts.

Two Public Information Centres (PICs) will be held during the course of the project. The PICs will provide stakeholders with an opportunity to meet the Project Team review the study scope and discuss issues related to the project including alternative solutions, environmental considerations and evaluation criteria. Details regarding the forthcoming PICs will be advertised as the study progresses.

Upon completion of the study, an Environmental Study Report will be submitted to the Ministry of the Environment and made available for public review for a period of 30 days. Subject to comments received and the receipt of necessary approvals, the Region intends to proceed with the detailed design and construction of this project.

#### Comments and Information

Please visit our website [www.peelregion.ca/pw/roads/enviro-assess](http://www.peelregion.ca/pw/roads/enviro-assess) for updates on the project. Comments and information regarding the study are being collected to assist the Region of Peel in meeting the requirements of the Environmental Assessment Act. This material will be maintained on file for use during the project and may be included in project documentation.

To provide comments or request additional information about this project, please contact either of the following team members:

**Mr. Hitesh Topiwala, MCIP, RPP**  
**Project Manager**  
**Regional Municipality of Peel**  
9445 Airport Road, 3<sup>rd</sup> Floor  
Brampton, ON L6S 4J3  
Telephone: 905-791-7800 ext. 7805  
Fax: 905-791-1442  
Email: [hitesh.topiwala@peelregion.ca](mailto:hitesh.topiwala@peelregion.ca)

**Mr. David Sinke, P.Eng.**  
**Project Manager**  
**AMEC Earth and Environmental**  
3215 North Service Road, Box 220  
Burlington, Ontario L7R 3Y2  
Telephone: 905-335-2353  
Toll Free: 1.886.751.2353  
Fax: 905-335-1414  
Email: [david.sinke@amec.com](mailto:david.sinke@amec.com)

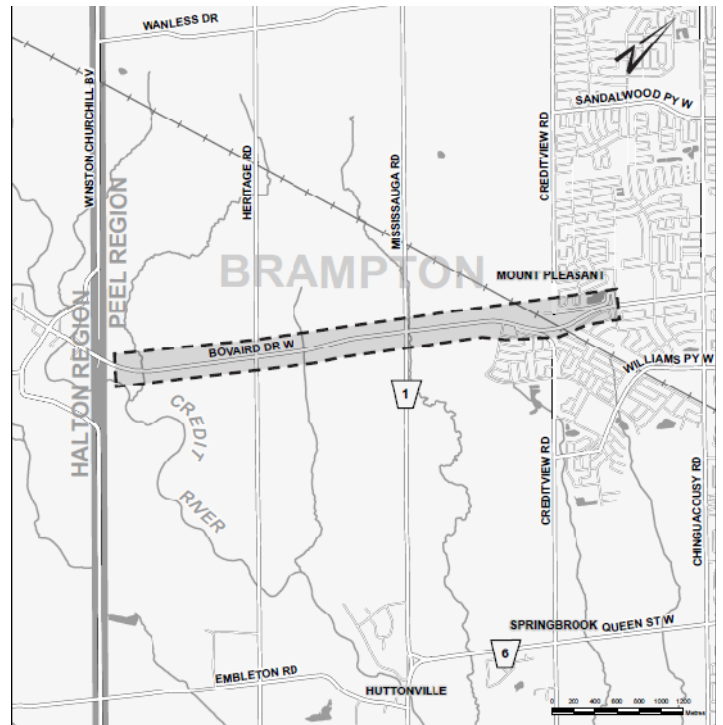

Information will be collected in accordance with the *Municipal Freedom of Information and Protection of Privacy Act*. With the exception of personal information, all comments will become part of the public record.

This notice was first issued on October 16, 2009.



October 16, 2009  
Project: 109089-12

Dear: Property Owner

**Re: Notice of Study Commencement:  
Bovaird Drive Class Environmental Assessment,  
From Lake Louise Drive/Worthington Avenue to 1.45km west of Heritage Road**

The Regional Municipality of Peel has retained AMEC Philips to undertake a Schedule 'C' Class Environmental Assessment Study to investigate improvements on Bovaird Drive from Lake Louise Drive/Worthington Avenue to 1.45km west of Heritage Road. A copy of the project "Notice of Study Commencement" is enclosed for your reference.

A key component of the study will be consultation with interested stakeholders (public and regulatory agencies) including two Public Information Centres (PICs). Details regarding the forthcoming PICs will be advertised as the study progresses.

If you wish to provide any comments on this study, prior to the first PIC, we request that your comments be directed to the following, no later than **November 11, 2009**.

**Mr. Hitesh Topiwala, MCIP, RPP**  
**Project Manager,**  
**Regional Municipality of Peel**  
Telephone: 905-791-7800 ext. 7805  
Fax: 905-791-1442  
Email: [hitesh.topiwala@peelregion.ca](mailto:hitesh.topiwala@peelregion.ca)

**Mr. David Sinke, P.Eng**  
**Project Manager**  
**AMEC Philips**  
3215 North Service Road, Box 220  
Burlington, ON L7R 3Y2  
Telephone: 905-335-2353  
Toll Free: 1.866.751.2353  
Fax: 905-335-1414  
Email: [david.sinke@amec.com](mailto:david.sinke@amec.com)

Throughout the next month, a topographic survey will be conducted along Bovaird Drive. A topographic survey identifies and records the existing physical and natural features on the ground such as driveways, trees, signs, etc. To complete this topographic survey, AMEC Philips, the project consultants, will be conducting actual field measurements to identify and record those property features described above, and it may be necessary to take measurements slightly beyond the road allowance, on your property.

This fieldwork will not involve any heavy equipment. If we are required to go onto your property it will only involve people walking on the property for short periods of time for measurement purposes. In addition to the field survey, consultants working with AMEC Philips

---

**Environment, Transportation and Planning Services**

9445 Airport Rd., 3rd Floor, Brampton, ON L6S 4J3  
Tel: 905-791-7800 [www.peelregion.ca](http://www.peelregion.ca)

will be in the area to perform various forms of fieldwork including a natural features survey, archeological assessment, surface water and groundwater surveys and a geotechnical borehole investigation.

If there is any concern with the survey fieldwork being conducted on your property, please contact the undersigned immediately.

We look forward to your assistance in the identification of pertinent issues affecting this project and thank you for your attention to this matter.

Sincerely,

A handwritten signature in black ink, appearing to read "Hitesh Topiwala", with a horizontal line underneath.

Hitesh Topiwala, MCIP, RPP  
Project Manager, Project Planning & Studies  
Environment, Transportation and Planning Services  
Region of Peel

Encl: Notice of Commencement

cc. David Sinke                      AMEC Philips

---

**Environment, Transportation and Planning Services**

9445 Airport Rd., 3rd Floor, Brampton, ON L6S 4J3  
Tel: 905-791-7800 [www.peelregion.ca](http://www.peelregion.ca)

# NOTICE OF STUDY COMMENCEMENT

## Municipal Class Environmental Assessment

### Regional Road 107 (Bovaird Drive) from Lake Louise Drive/Worthington Avenue to 1.45km west of Heritage Road

#### The Study

The Regional Municipality of Peel has initiated a Municipal Class Environmental Assessment for improvements to Bovaird Drive from Lake Louise Drive/Worthington Avenue to 1.45km west of Heritage Road. The approximate limits of the project area are illustrated on the key plan. The Region of Peel in conjunction with Halton Region, Town of Caledon, City of Brampton and Town of Halton Hills is undertaking the Halton Peel Boundary Area Transportation Study (HPBATS) which is expected to be completed in 2010. The west study limit of the Bovaird Drive EA may be reviewed based on the recommendations of HPBATS and the project scope revised accordingly.

The study will examine the need and feasibility for widening and improvements on Bovaird Drive to address short term and long term issues related to planned future growth, operational, geometric, capacity and storm drainage deficiencies.

#### The Process

The study is being conducted in accordance with the requirements for a Schedule "C" project as described in the Municipal Engineers Association's Municipal Class Environmental Assessment (EA) document (October 2000, as amended in 2007), which is approved under the *Ontario Environmental Assessment Act*. The Class EA process will include public and agency consultation, an evaluation of road improvement alternatives, an assessment of the potential environmental effects of the proposed improvements and identification of reasonable measures to mitigate any adverse impacts.

Two Public Information Centres (PICs) will be held during the course of the project. The PICs will provide stakeholders with an opportunity to meet the Project Team review the study scope and discuss issues related to the project including alternative solutions, environmental considerations and evaluation criteria. Details regarding the forthcoming PICs will be advertised as the study progresses.

Upon completion of the study, an Environmental Study Report will be submitted to the Ministry of the Environment and made available for public review for a period of 30 days. Subject to comments received and the receipt of necessary approvals, the Region intends to proceed with the detailed design and construction of this project.

#### Comments and Information

Please visit our website [www.peelregion.ca/pw/roads/environ-assess](http://www.peelregion.ca/pw/roads/environ-assess) for updates on the project. Comments and information regarding the study are being collected to assist the Region of Peel in meeting the requirements of the Environmental Assessment Act. This material will be maintained on file for use during the project and may be included in project documentation.

To provide comments or request additional information about this project, please contact either of the following team members:

**Mr. Hitesh Topiwala, MCIP, RPP**  
Project Manager  
Regional Municipality of Peel  
9445 Airport Road, 3<sup>rd</sup> Floor  
Brampton, ON L6S 4J3  
Telephone: 905-791-7800 ext. 7805  
Fax: 905-791-1442  
Email: [hitesh.topiwala@peelregion.ca](mailto:hitesh.topiwala@peelregion.ca)

**Mr. David Sinke, P.Eng.**  
Project Manager  
AMEC Earth and Environmental  
3215 North Service Road, Box 220  
Burlington, Ontario L7R 3Y2  
Telephone: 905-335-2353  
Toll Free: 1.886.751.2353  
Fax: 905-335-1414  
Email: [david.sinke@amec.com](mailto:david.sinke@amec.com)

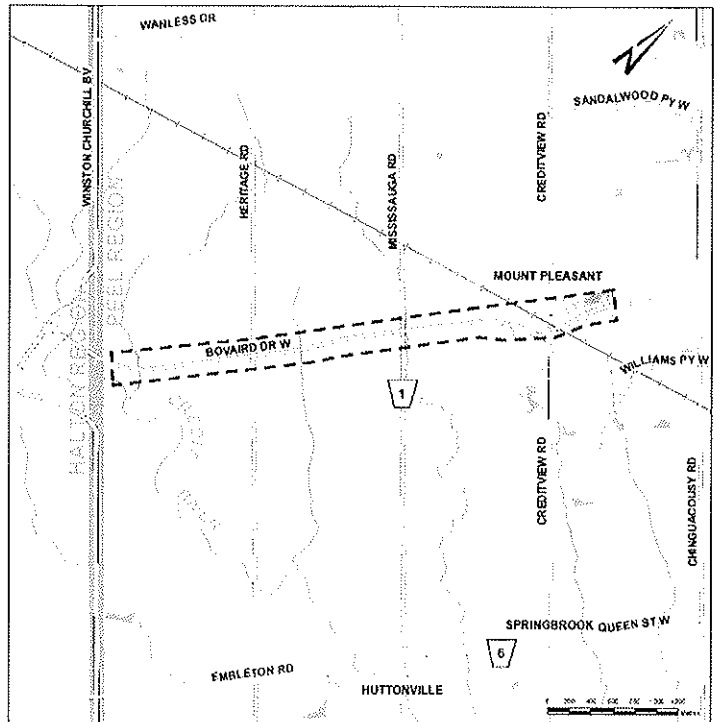

Information will be collected in accordance with the *Municipal Freedom of Information and Protection of Privacy Act*. With the exception of personal information, all comments will become part of the public record.

This notice was first issued on October 16, 2009.

**Region of Peel**  
Working for you



October 14, 2009

Environmental Unit  
Re. Environmental Assessment Coordination  
Indian and Northern Affairs  
25 St. Clair Avenue East, 8th Floor  
Toronto, ON  
M4T 1M2

Dear :

**RE: Notice of Study Commencement: Bovaird Drive Class Environmental Assessment,  
From Lake Louise Drive/Worthington Avenue to 1.45 km west of Heritage Road**

The Region of Peel is initiating a Municipal Class Environmental Assessment (Class EA) Study for improvements to Bovaird Drive from Lake Louise Drive/Worthington Avenue to 1.45km west of Heritage Road. The purpose of this letter is to inform you of the study and invite your input. A copy of the notice is attached.

The study is being conducted in accordance with the approved requirements for a Schedule "C" project as described in the Municipal Engineers Association's Municipal Class Environmental Assessment (EA) document (October 2000, as amended in 2007) which is approved under the *Ontario Environmental Assessment Act*.

The study will:

- review current and future levels of service on Bovaird Drive with consideration for existing and future growth and development along the corridor;
- identify problems and opportunities for improvements; and
- recommend a solution through a comprehensive and environmentally sound planning process, with public participation.

A key component of the study will be consultation with interested stakeholders (public and regulatory agencies) including two Public Information Centres (PICs). Details regarding the forthcoming PICs will be advertised as the study progresses.

Over the next few weeks, the project team, including a number of environmental sub-consultants, may be contacting your office directly for environmental conditions information or mapping for the study area. Your assistance with our secondary source investigation is greatly appreciated.

---

**Environment, Transportation and Planning Services**

9445 Airport Rd., 3rd Floor, Brampton, ON L6S 4J3  
Tel: 905-791-7800 [www.peelregion.ca](http://www.peelregion.ca)

To request additional information or provide comments about the study, please complete the enclosed Response Form or contact the undersigned.

Yours truly,



**Hitesh Topiwala, MCIP, RPP**

Project Manager, Project Planning and Studies  
Environment, Transportation and Planning Services

Region of Peel

Phone No.: 905-791-7800 ext. 7805

Fax No.: 905-791-1442

Email: [hitesh.topiwala@peelregion.ca](mailto:hitesh.topiwala@peelregion.ca)

Encl.: Notice of Study Commencement and "Fax Back" Response Form

c.c. David Sinke AMEC Philips

---

**Environment, Transportation and Planning Services**

9445 Airport Rd., 3rd Floor, Brampton, ON L6S 4J3

Tel: 905-791-7800 [www.peelregion.ca](http://www.peelregion.ca)



**Comment Sheet**

October 14, 2009  
Our File: 109089-12

**ATTENTION:** Hitesh Topiwala, Region of Peel  
**FAX NUMBER:** 905-791-1442  
**FROM:** «Title» «First\_Name» «Last\_Name»  
«Position\_\_»

**Re:** Bovaird Drive Class Environmental Assessment, From Lake Louise Drive/Worthington Avenue to 1.45 km west of Heritage Road

- We have no concerns and do not need to be involved in this study.
  - We have no concerns at this time, but wish to remain on the contact list for this study.
  - We have the following comment(s) and/or information requirements.
- \_\_\_\_\_
- \_\_\_\_\_
- \_\_\_\_\_
- \_\_\_\_\_
- \_\_\_\_\_
- \_\_\_\_\_
- \_\_\_\_\_
- \_\_\_\_\_
- \_\_\_\_\_
- \_\_\_\_\_
- \_\_\_\_\_
- \_\_\_\_\_
- \_\_\_\_\_
- \_\_\_\_\_
- \_\_\_\_\_
- \_\_\_\_\_
- \_\_\_\_\_
- \_\_\_\_\_
- \_\_\_\_\_



# NOTICE OF STUDY COMMENCEMENT

## Municipal Class Environmental Assessment

### Regional Road 107 (Bovaird Drive) from Lake Louise Drive/Worthington Avenue to 1.45km west of Heritage Road

#### The Study

The Regional Municipality of Peel has initiated a Municipal Class Environmental Assessment for improvements to Bovaird Drive from Lake Louise Drive/Worthington Avenue to 1.45km west of Heritage Road. The approximate limits of the project area are illustrated on the key plan. The Region of Peel in conjunction with Halton Region, Town of Caledon, City of Brampton and Town of Halton Hills is undertaking the Halton Peel Boundary Area Transportation Study (HPBATS) which is expected to be completed in 2010. The west study limit of the Bovaird Drive EA may be reviewed based on the recommendations of HPBATS and the project scope revised accordingly.

The study will examine the need and feasibility for widening and improvements on Bovaird Drive to address short term and long term issues related to planned future growth, operational, geometric, capacity and storm drainage deficiencies.

#### The Process

The study is being conducted in accordance with the requirements for a Schedule "C" project as described in the Municipal Engineers Association's Municipal Class Environmental Assessment (EA) document (October 2000, as amended in 2007), which is approved under the *Ontario Environmental Assessment Act*. The Class EA process will include public and agency consultation, an evaluation of road improvement alternatives, an assessment of the potential environmental effects of the proposed improvements and identification of reasonable measures to mitigate any adverse impacts.

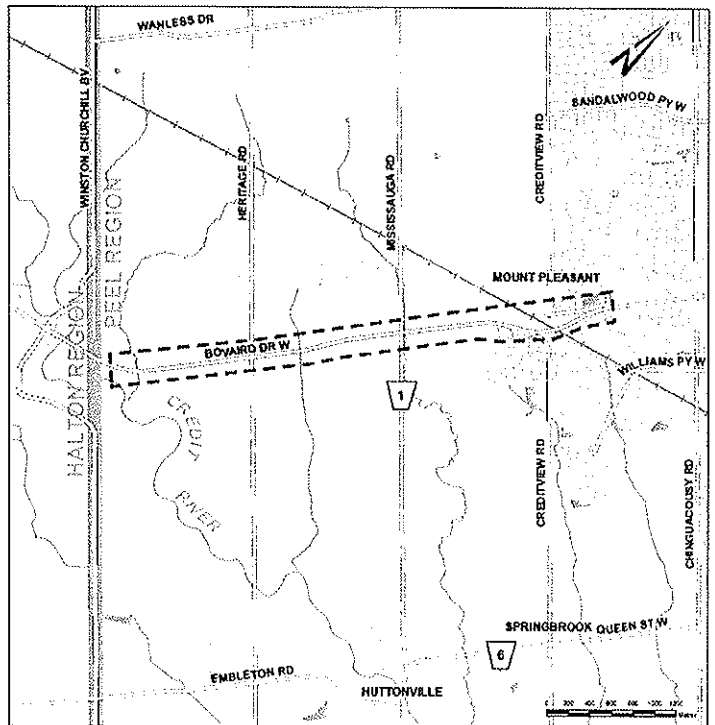

Two Public Information Centres (PICs) will be held during the course of the project. The PICs will provide stakeholders with an opportunity to meet the Project Team review the study scope and discuss issues related to the project including alternative solutions, environmental considerations and evaluation criteria. Details regarding the forthcoming PICs will be advertised as the study progresses.

Upon completion of the study, an Environmental Study Report will be submitted to the Ministry of the Environment and made available for public review for a period of 30 days. Subject to comments received and the receipt of necessary approvals, the Region intends to proceed with the detailed design and construction of this project.

#### Comments and Information

Please visit our website [www.peelregion.ca/pw/roads/environ-assess](http://www.peelregion.ca/pw/roads/environ-assess) for updates on the project. Comments and information regarding the study are being collected to assist the Region of Peel in meeting the requirements of the Environmental Assessment Act. This material will be maintained on file for use during the project and may be included in project documentation.

To provide comments or request additional information about this project, please contact either of the following team members:

**Mr. Hitesh Topiwala, MCIP, RPP**  
Project Manager  
Regional Municipality of Peel  
9445 Airport Road, 3<sup>rd</sup> Floor  
Brampton, ON L6S 4J3  
Telephone: 905-791-7800 ext. 7805  
Fax: 905-791-1442  
Email: [hitesh.topiwala@peelregion.ca](mailto:hitesh.topiwala@peelregion.ca)

**Mr. David Sinke, P.Eng.**  
Project Manager  
AMEC Earth and Environmental  
3215 North Service Road, Box 220  
Burlington, Ontario L7R 3Y2  
Telephone: 905-335-2353  
Toll Free: 1.886.751.2353  
Fax: 905-335-1414  
Email: [david.sinke@amec.com](mailto:david.sinke@amec.com)

Information will be collected in accordance with the *Municipal Freedom of Information and Protection of Privacy Act*. With the exception of personal information, all comments will become part of the public record.

This notice was first issued on October 16, 2009.

 **Region of Peel**  
Working for you



Mr. Dave Bell  
Senior Program Officer  
Canadian Environmental Assessment Agency - Ontario  
Region  
55 St. Clair Avenue East, Suite 907  
Toronto, ON M4T 1M2

Mr. Marc-Andre Millaire  
Litigation Team Leader  
Indian and Northern Affairs  
10 Wellington Street  
Gatineau, QC K1A 0H4

Mr. Gregg Dahl  
Senior Policy Analyst  
Office of the Federal Interlocutor for Metis and non-  
status Indians  
66 Slater Street, Room 1218  
Ottawa, ON K1A 0H4

Environmental Unit  
Re. Environmental Assessment Coordination  
Indian and Northern Affairs  
25 St. Clair Avenue East, 8th Floor  
Toronto, ON M4T 1M2

Ms. Cindy Latendresse  
Admin. Asst / Co-ordinator  
Fisheries and Oceans Canada  
3027 Harvester Road, Unit 304  
Burlington ON L7R 4K3

Sir/Madam  
Chiefs of Ontario Office  
111 Peter Street Suite 806  
Toronto ON M5V 2H1

Mr. Richard Saunders  
Director - Negotiations, Negotiations Branch  
Ontario Secretariat for Aboriginal Affairs  
720 Bay Street, 4th Floor  
Toronto ON M5G 2K1

Ms. Nicole Cheechoo  
Policy Analysis Treaties and Aboriginal Government  
Indian and Northern Affairs  
10 Wellington Street, 8th Floor  
Gatineau, QC K1A 0H4

Mr. Don Boswell  
Senior Claims Analyst Specific Claims Branch Ontario  
Research Team  
Indian and Northern Affairs Canada  
10 Wellington Street, Room 1310  
Gatineau, QC K1A 0H4

Mr. Glenn Gilbert  
Environmental Unit, Lands and Trusts Services  
Indian and Northern Affairs Canada  
25 St. Clair Avenue East, 8th Floor  
Toronto, ON M4T 1M2

Mr. Allan Dokis  
Intergovernmental Affairs Director  
Anishinabek Nation/Union of Ontario Indians,  
Nipissing First Nation  
P.O. Box 711  
North Bay ON P1B 8J8

Ms. Rolanda Elijah  
Director of Intergovernmental Affairs  
Association of Iroquois and Allied Indians  
387 Princess Avenue  
London ON N6B 2A7

Sir/Madam  
Chippewas of Georgina Island  
RR2, PO Box 13  
Sutton West ON L0E 1R0

Chief William Montour  
Six Nations Council - Land and Resources  
2498 Chiefswood Road, P.O. Box 5000  
Ohsweken ON N0A 1M0

Chief Greg Cowie  
Hiawatha First Nation  
123 Paudash Street, R.R. #6  
Keene ON K0L 2G0

Chief Keith Knott  
Curve Lake First Nation  
22 Winookeeda Road  
Curve Lake ON K0L 1R0

Mr. J. Budz  
District Manager  
Ministry of the Environment  
Halton-Peel District Office  
4145 North Service Road, Suite 300  
Burlington ON L7L 6A3

Chief Brian Laferme  
Chief  
Mississaugas of the New Credit First Nation  
2789 Mississauga Road, R.R. 6  
Hagersville ON N0A 1M0

Chief Tracy Gauthier  
Mississaugas of the Scugog Island  
22521 Island Road  
Port Perry ON L9L 1B6

Chief James R. Marsden  
Alderville First Nation  
PO Box 46, R.R. #4  
Roseneath ON K0K 2X0

Grand Chief Konrad Sioui  
Conseil de la Nation Huronne-Wendat  
255, rue Chef-Michel Laveau  
Wendake, QC G0A 4V0

Mr. Liam Marray  
Senior Planner / Ecologist  
Credit Valley Conservation Authority  
1225 Old Derry Road  
Mississauga ON L5N 6R4

Ms. Shannon McNeil  
Environmental Resource Planner and EA Coordinator  
Ministry of the Environment  
5775 Yonge Street, 8th Floor  
North York ON M2M 4J1

Ms. Tracy Goodwin  
District Manager  
Ministry of the Environment  
Halton-Peel District Office  
4145 North Service Road, Suite 300  
Burlington ON L7L 6A3

Mr. Tracy Smith  
District Manager  
Ministry of Natural Resources  
Aurora District  
50 Bloomington Road West  
Aurora ON L4G 3G8

Ms. Carol Newmann  
Rural Planner  
Ministry of Agricultural, Food and Rural Affairs  
Agricultural Land Use  
RR1 Fergus, ON N1M 2W5

Mr. Anil Wijesoorya  
General Manager, Planning Services  
Ontario Realty Corporation  
1 Dundas Street West, Suite 2000  
Toronto ON M5G 2L5

Ms. Sheryl Bennett  
Senior Officer  
Accommodation Services Section  
Ontario Provincial Police  
777 Memorial Avenue, 1st Floor  
Orillia ON L3V 7V3

Mr. W.M.C. Wilson  
Environmental Planner  
Government of Ontario, Management Board Secretariat  
Land Development Branch  
16th Floor, 777 Bay Street  
Toronto ON M5G 2E5

Mr. Ted Lagakos  
Corridor Management Technician  
Ministry of Transportation  
1201 Wilson Avenue  
7th Floor, Atrium Tower  
Downsview ON M3M 1J8

Mr. Alan Kary  
Deputy Director  
Ministry of Aboriginal Affairs, Policy and Relationships  
Branch  
720 Bay Street, 4th Floor  
Toronto ON M5G 2K1

Mr. Winston Wong  
Heritage Planner  
Ministry of Culture  
Culture Services Unit  
400 University Avenue, 4th Floor  
Toronto ON M7A 2R9

Mr. Julius Lindsay  
Reporting Specialist  
Ontario Realty Corporation  
1 Dundas Street West, Suite 2000  
Toronto ON M5G 2L5

Mr. Michael Johnson  
Manager Culture, Sport Recreation  
Ministry of Culture  
400 University Avenue, 4th Floor  
Toronto ON M7A 2R9

Mr. Tim Haldenby  
Senior Planner  
Provincial Planning and Environmental Services Branch  
Ministry of Municipal Affairs and Housing  
777 Bay Street, 14 Floor  
Toronto ON M5G 2E5

Mr. Lou Politano  
Manager  
Ministry of Transportation, Engineering Office  
1201 Wilson Avenue, 4th Floor, Atrium Tower  
Downsview ON M3M 1J8

Ms. Dorothy Moxzynski  
EA Co-ordinator  
Ministry of the Environment,  
Central Regional Office  
2775 Yonge Street, 6th floor,  
Place Nouveau Bidg.  
North York, ON M2M 1P5

Mr. Greg Ashlee  
Manager, Transportation Planning and Development  
GO Transit  
GO Transit  
20 Bay Street, Suite 600  
Toronto, ON M5J 2W3

Mr. Paul Mountford  
Intermediate Planning Officer  
Peel District School Board  
H.J.A. Brown Education Centre  
5650 Hurontario Street  
Mississauga ON L5R 1C6

Ms. Rosmary Keenan  
Interim Chair  
Brampton Environmental Community Advisory Panel  
CAW Hall, 23 Regan Road  
Brampton ON L7A 1B2

Mr. J.P. Melito  
Superintendent of Planning and Operations  
Dufferin-Peel Catholic District School Board  
40 Matheson Boulevard West  
Mississauga ON L5R 1C5

Mr. R.E. LeMay  
Superintendent of Business Affairs  
Dufferin-Peel Catholic District School Board  
40 Matheson Boulevard West  
Mississauga ON L5R 1C5

Ms. Lynn Chaput  
Bell Canada  
Municipal Operations Centre  
100 Borough Drive, Floor 5 Blue  
Scarborough ON M1P 4W2

Ms. Carol Goossens  
Bell Canada  
20 Hunter Street West, 6th Floor  
Hamilton ON L8N 3H2

Ms. Janice Young  
Manager - Right of Way  
Bell Canada  
F3 Section Green  
100 Borough Drive  
Scarborough ON M1P 4W2

Mr. Greg Johnson  
AT & T Canada  
50 Galaxy Boulevard  
Etobicoke ON M9W 5X2

Mr. Anthony Segreto  
Telus Communications  
11 King Street West, 11th Floor  
Toronto ON M5H 4C7

Mr. Camelo Tancioco  
Manager of Special Projects  
Enbridge Gas Distribution Inc.  
P.O. Box 650, STN A  
Scarborough ON M1K 5E3



Mr. Kerry Dick  
Enbridge Gas Distribution Inc.  
Construction and Maintenance Department  
6 Colony Court  
Brampton ON L6T 4E4

Mr. Russ McLean  
Manager of Distribution Planning  
Enbridge Gas Distribution Inc.  
500 Consumers Road  
North York ON M2J 1P8

Ms. Angatha Le Donne  
Planning Co-ordinator  
Rogers Cable TV Limited  
3573 Wolfedale Road  
Mississauga ON L5C 3T6

Mr. Vito Cassano  
System Planner  
Rogers Cable TV Limited  
3573 Wolfedale Road  
Mississauga ON L5C 3T6

Mr. Walter Watt  
Coordinator Crossings and Pipelines  
Trans-Northern Pipelines  
45 Vogell Road Suite 310  
Richmond Hill ON L4B 3P6

Ms. Katherine Lange  
Trans Canada Pipelines  
11200 Weston Road P.O. Box 790  
Maple ON L6A 1S7

Mr. Alfred Roth  
C.E.T.  
Union Gas  
360 Strathearne Avenue North  
Toronto ON L8H 5L1

Mr. Brian McCormick  
Manager, Environmental Services and Approvals  
Hydro One Networks Inc.  
483 Bay Street 14th Floor  
Toronto ON M5G 2P5

Ms. Marion Wright  
OPE Coordinator - GTA West  
Rogers Cable TV Limited  
3573 Wolfedale Road  
Mississauga ON L5C 3T6

Ms. Susan Fennell  
Mayor  
City of Brampton  
2 Wellington Street West  
Brampton ON L6Y 4R2

Mr. John Sanderson  
Regional Councillor - Ward 4  
City of Brampton  
2 Wellington Street West  
Brampton ON L6Y 4R3

Mr. Paul Palleschi  
Regional Councillor - Ward 6  
City of Brampton  
2 Wellington Street West  
Brampton ON L6Y 4R4

Mr. Bob Callahan  
City Councillor - Ward 4  
City of Brampton  
2 Wellington Street West  
Brampton ON L6Y 4R5

Mr. John Hutton  
City Councillor - Ward 6  
City of Brampton  
2 Wellington Street West  
Brampton ON L6Y 4R6

Mr. Gene Carazzola  
Project Leader - AcceleRide  
Brampton Transit  
8850 McLaughlin Road, Unit 2  
Brampton ON L6Y 5T1

Ms. Lisa Clark  
Planning Co-ordinator  
Brampton Transit  
185 Clark Boulevard  
Brampton ON L6T 3J1

Ms. Rosmary Keenan  
Interim Chair  
Brampton Environmental Community Advisory Panel  
CAW Hall, 23 Regan Road  
Brampton ON L7A 1B2

Mr. Jim Leonard  
Heritage Co-ordinator  
COB, for Brampton Heritage Board  
2 Wellington Street West  
Brampton ON L6Y 4R6

Mr. Chris Duyvestyn  
Manager, Infrastructure Planning, Works and  
Transportation  
City of Brampton  
8850 McLaughlin Road  
Brampton ON L6Y 5T1

Mr. Peter F. Dundas  
Director, Ambulance and Emergency Programs  
Peel Regional Paramedic Services (EMS)  
5299 Maingate Drive  
Mississauga ON L4W 1G8

Mr. Lincoln Kahn  
Manager, Environmental Services  
City of Mississauga  
City Centre  
Mississauga ON

Mr. Mike Grodzinski  
Operation Planning and Resources  
Peel Region Police Department  
7750 Hurontario Street  
Brampton ON L6V 3W6

Chief H. M. Metcalf  
Peel Region Police  
Attention: Sergeant Dale Waller  
7750 Hurontario Street  
Brampton ON L6V 3W6

Chief Andrew MacDonald  
Chief, Brampton Fire  
Brampton Fire and Emergency Services  
8 Rutherford Road South  
Brampton ON L6W 3J1



109089-12  
✓✓



Canadian Environmental  
Assessment Agency

Agence canadienne  
d'évaluation environnementale

55 St. Clair Avenue East  
Suite 907  
Toronto, Ontario  
M4T 1M2

55, avenue St-Clair Est  
Bureau 907  
Toronto (Ontario)  
M4T 1M2

October 30, 2009

Hitesh Topiwala, MCIP, RPP  
Project Manager, Project Planning and Studies  
Environment, Transportation and Planning Services  
Region of Peel  
9445 Airport Road, 3<sup>rd</sup> Floor  
Brampton, Ontario  
L6S 4J3

Dear Mr. Topiwala,

**Re: Bovaird Drive Class Environmental Assessment**

Thank you for your letter dated October 14, 2009, related to the above-noted project.

The *Canadian Environmental Assessment Act* (the Act), applies to federal authorities when they contemplate certain action or decisions in relation to a project that would enable it to proceed in whole or in part. A federal environmental assessment (EA) may be required when a federal authority:

- a) is the proponent of the project;
- b) provides financial assistance to the proponent;
- c) sells, leases or otherwise disposes of federal lands; or
- d) issues a permit, licence or any other approval as prescribed in the *Law List Regulations*.

In the case of projects that are subject to the Ontario *Environmental Assessment Act*, if there is uncertainty as to whether the Act may also apply, the Agency can help proponents answer this question. For projects that are subject to the Act, the Agency will act as the federal environmental assessment coordinator and facilitate the involvement of the federal authorities in a co-ordinated assessment aimed at meeting all agencies' needs simultaneously.

.../2



In order for the Agency to undertake either of these roles, it must have a project description that can be distributed to various federal authorities to determine their interest in the project. It is recognized that at the early stages of the planning process, there may not be much detailed information to provide. However, proponents should try to provide some information on:

- the nature of the project and its location;
- federal decisions which may be made in relation to the project;
- whether federal funding is being contemplated or federal lands are required.

To better assist proponents, the Agency has developed an Operational Policy Statement, which provides guidance in preparing project descriptions. This is available on the Agency's website at:  
[http://www.ceaa-acee.gc.ca/013/0002/ops\\_ppd\\_e.htm](http://www.ceaa-acee.gc.ca/013/0002/ops_ppd_e.htm)

If your purpose in sending us notification of your project is to determine whether the *Canadian Environmental Assessment Act* applies, please be aware that simple notification will not be sufficient. A project description will be required.

**Important Note:** Please be aware that release of documents to the public may be part of the EA process. Information provided by you related to the EA for this project will be part of the Canadian Environmental Assessment Registry and will be made available to members of the public, if requested. A package with additional information will be provided to you upon submission of the project description. Should you provide any documents that contain confidential or sensitive information that you believe should be protected from release to the public, please contact the undersigned to obtain an Exclusion Form. This Form can be used to identify the information to be considered for exclusion from the Canadian Environmental Assessment Registry and the rationale for the exclusion.

If you have any questions regarding any of the above, please contact the undersigned at 416-952-7006.

Sincerely,

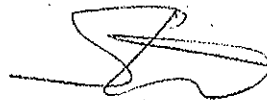

Steve Woolfenden, Project Manager  
Canadian Environmental  
Assessment Agency, Ontario Region

SW/js

109089-12  
✓✓

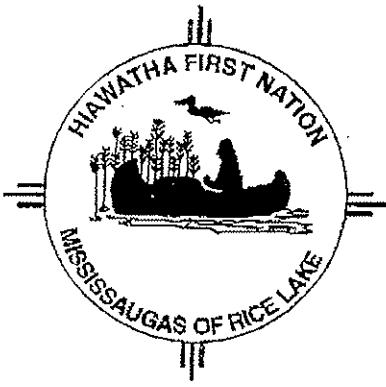

# hiawatha first nation

band administration office, R.R. 2, Keene, Ontario K0L 2G0  
telephone (705) 295-4421 Fax (705) 295-4424

RECEIVED

OCT 30 2009

## FAX TRANSMISSION

To: Hitesh Topiwala Date: Oct. 29/09

Fax #: 905-791-1447 Pages: 3, including this cover sheet

From: Diane Sheridan

Subject: Bouvard Drive Improvements

### COMMENTS:

Find attached information we  
would like please

Miigwetch  
SD

IF ANY INFORMATION IS MISSING OR DOES NOT PRINT OUT  
CLEARLY, PLEASE CALL OUR OFFICE AND WE WILL GLADLY SEND  
ANOTHER COPY.

**Comment Sheet**

October 14, 2009  
Our File: 109089-12

**ATTENTION:** Hitesh Topiwala, Region of Peel  
**FAX NUMBER:** 905-791-1442  
**FROM:** Chief Greg Cowie

**Re:** Bovaird Drive Class Environmental Assessment, From Lake Louise Drive/Worthington Avenue to 1.45 km west of Heritage Road

- We have no concerns and do not need to be involved in this study.
- We have no concerns at this time, but wish to remain on the contact list for this study.
- We have the following comment(s) and/or information requirements:

*We would like the information outlined in the attached letter.*



# hiawatha first nation

band administration office, R.R. 2, Keene, Ontario K0L 2G0  
telephone (705) 295-4421 Fax (705) 295-4424

*On behalf of Hiawatha First Nation we, Diane Sheridan and Lori Ritter, would like to introduce ourselves as the consultation contacts for Hiawatha First Nation.*

*In order for us to update our files and more efficiently go through the duty to consult process we require additional information about the*

Bovard Drive Improvements

project.

*The information that we require is:*

- 1. What stage your project is currently in?*
- 2. What environmental issues have been identified?*
- 3. What type or types of mitigation is proposed?*
- 4. Is there an archaeological investigation or will there be one?*
- 5. Will there be any treaty or inherent rights affected during the process?*

*We thank you in advance for your timely response to better enable us to decide whether input is required on behalf of Hiawatha First Nation.*

*Yours truly,*

*Lori Ritter & Diane Sheridan*

*Consultation Contacts – Hiawatha First Nation*





Ontario Realty Corporation  
Société immobilière de l'Ontario

1 Dundas Street West  
Suite 2000  
Toronto, Ontario  
Tel: 416-327-3937

1, rue Dundas Ouest  
Bureau 2000  
Toronto, Ontario  
Fax: 416-212-1131

109089-12  
✓✓

November 2, 2009

To Hitesh Topiwala,

**RE: Notice of Study Commencement: Bovaird Drive Class Environmental Assessment  
from Lake Louise Drive/Worthington Avenue to 1.45 km west of Heritage Road**

Thank you for circulating Ontario Realty Corporation (ORC) on your Notice of Study Commencement. The ORC is the strategic manager of the government's real property with a mandate of maintaining and optimizing value of the portfolio, while ensuring real estate decisions reflect public policy objectives of the government.

Our preliminary review of your notice and supporting information indicates that ORC-managed property is not within your study area. We have no other concerns with this undertaking. Please remove ORC from your circulation list with respect to this project.

Thank you for the opportunity to provide initial comments on this undertaking. If you have any questions I can be reached at the contacts below.

Sincerely,

A handwritten signature in cursive script that reads "Lisa Myslicki".

**Lisa Myslicki**  
Environmental Coordinator  
Ontario Realty Corporation - Professional Services  
1 Dundas Street West,  
Suite 2000, Toronto, Ontario  
M5G 2L5  
(416) 212-3768  
[lisa.myslicki@ontariorealty.ca](mailto:lisa.myslicki@ontariorealty.ca)

109089-12  
✓

**Dearlove, Heather**

---

**Subject:** FW: Bovaird Drive Class EA - File 109089-12  
**Attachments:** 15473 Peel Bovaird EA Response ltr.pdf

---

**From:** [REDACTED]  
**Sent:** November 12, 2009 1:47 PM  
**To:** Topiwala, Hitesh  
**Subject:** Bovaird Drive Class EA - File 109089-12

Good Afternoon Hitesh,

Further to your notice October 14<sup>th</sup> regarding the EA noted above, attached are some preliminary comments. Please forward future study details to my attention as well as any future projects/circulations which may affect TransCanada PipeLines Limited.

If you have any questions let me know.

Thank you,

Darlene Presley

TransCanada PipeLines Limited  
C/O Lehman & Associates  
97 Collier Street, Barrie, ON L4M 1H2  
Phone: 1-866-602-0663  
Direct: 705-627-2302  
Fax: 705-727-9217

Email [darlene@lehmanplan.ca](mailto:darlene@lehmanplan.ca)

November 12, 2009

Hitesh Topiwala, MCIP, RPP  
The Region of Peel  
Environment, Transportation and Planning Services  
9445 Airport Road, 3<sup>rd</sup> Floor  
Brampton, ON  
L6S 4J3

Via email: [Hitesh.topiwala@peelregion.ca](mailto:Hitesh.topiwala@peelregion.ca)

Dear Hitesh:

**Re: Bovaird Drive Class Environmental Assessment  
Your File No. 109089-12  
Our File No. PAR 15473**

We have received notice of the EA noted above. TransCanada has one high pressure natural gas pipeline crossing Bovaird Drive West between Mississauga Rd. and Heritage Rd. TransCanada reviews all development within 200 metres of its facilities to ensure that it does not affect the safety and integrity of those facilities.

Please be advised of the following TransCanada and National Energy Board requirements for any development in close proximity to the pipeline for consideration in the EA Report:

1. All crossings of the pipeline right-of-way by any facility as defined by the National Energy Board (NEB) Regulation 112 must have TransCanada's prior written authorisation. A crossing facility may include but is not limited to driveways, roads, access ramps, trails, pathways or utilities. In accordance with the NEB Act, the owner may be required to enter into a crossing agreement with TransCanada prior to the construction of any facility. The owner agrees to meet all clearances and design requirements outlined in the crossing agreement and the NEB Pipeline Crossing Regulations.
2. Any grading not otherwise permitted by the NEB Act or Crossing Regulations, that will affect the right-of-way or drainage onto it, regardless of whether or not the grading is conducted on the right-of-way, must receive TransCanada's prior written approval. Grading activities on the right-of-way will only be permitted when a TransCanada representative is present to inspect and supervise them.

---

**LEHMAN**  
& ASSOCIATES

Authorized commenting Agency for

97 Collier St.,  
Barrie, ON L4M 1H2  
(705) 727-0663



3. Section 112 of the NEB Act requires that anyone excavating with power-operated equipment or explosives within 30m of the pipeline right-of-way must obtain leave from the pipeline company before starting any work. To satisfy this NEB requirement, you may send your request for leave directly to TransCanada with supporting information explaining how the work will be carried out. Once you obtain written approval for your excavation request, you must notify TransCanada at 1-800-827-5094 or Ontario One Call at 1-800-400-2255 15 business days before the start of any excavation using power-operated equipment and 30 business days before the use of explosives within 30m of the pipeline right-of-way limits.
4. Notice must be given to TransCanada directly (1-800-827-5094) or through Ontario One Call (1-800-400-2255) a minimum of 15 business days before the start of any construction on or within 30m of the pipeline right-of-way and 30 business days before conducting any work involving explosives.
5. The Owner shall ensure through all contracts entered into, that all contractors and subcontractors are aware of and observe the foregoing terms and conditions.

Please forward details of the EA study when they become available. If you have any questions, please contact our office.

Sincerely,

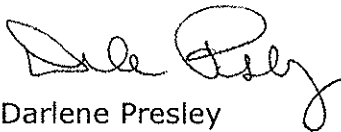

Darlene Presley

---

**LEHMAN**  
**& ASSOCIATES**

Authorized commenting Agency for

97 Collier St.,  
Barrie, ON L4M 1H2  
(705) 727-0663



**TransCanada**  
*In business to deliver*

109089-12  
✓✓

**Dearlove, Heather**

---

**Subject:** FW: Bovaird Drive Class Environmental Assessment

**From:** Topiwala, Hitesh [mailto:Hitesh.Topiwala@peelregion.ca]  
**Sent:** Thursday, November 19, 2009 10:57 AM  
**To:** 'Stowe, David'  
**Cc:** Rieger, Doug; DeJager, Shawn; Parajuli, Bishnu; Sinke, David; Brock, Liz  
**Subject:** RE: Bovaird Drive Class Environmental Assessment

Hello David,

Thank you for this information. We usually co-ordinate all our EA's through Chris Duyvestyn's group and Bishnu is usually our primary contact for such co-ordination and provides comments from all staff at the City. We contact staff directly for further input as needed.

I understand that you must have received a separate notice of commencement. However, we are trying to avoid multiple notices being sent out to City staff to avoid duplication and confusion. This seems to be an error on our end. I will have our contact list updated.

Once again, we appreciate your input and you will have the opportunity to review, comment and provide input at all stages of the EA.

Thank you,

Hitesh Topiwala

---

**From:** Stowe, David [mailto:David.Stowe@brampton.ca]  
**Sent:** November 19, 2009 8:50 AM  
**To:** Topiwala, Hitesh  
**Cc:** Rieger, Doug; DeJager, Shawn  
**Subject:** Bovaird Drive Class Environmental Assessment

Hitesh:

Brampton Transit currently operates a number of services within the study area, primarily to and from the Mount Pleasant GO Station across the Bovaird Corridor and through the adjacent residential areas to the east and south. In the future, transit services are planned to extend to the west along the Bovaird Corridor, including a future planned Bus Rapid Transit corridor along Bovaird Drive to Mississauga Road.

As such, we would like the opportunity to review and comment on the draft EA report, from a transit planning perspective.

Also, could you please change the primary contact for Brampton Transit from Lisa Clark to Doug Rieger, Manager of Service Development.

Thank you for your attention to these matters. If you have any questions or require additional information, please do not hesitate to contact me.

**David Stowe**

109089-12  
✓✓

**Dearlove, Heather**

---

**Subject:** FW: Bovaird Drive Class EA  
**Attachments:** Bovaird Drive Class EA.doc

---

**From:** Enneson, Jean (MNR) [mailto:Jean.Enneson@ontario.ca]  
**Sent:** November 25, 2009 3:24 PM  
**To:** Topiwala, Hitesh  
**Cc:** Heaton, Mark (MNR); Thompson-Black, Melinda (MNR)  
**Subject:** Bovaird Drive Class EA

Dear Mr. Topiwala

Please find attached a response to the Notice of Study Commencement for the Bovaird Drive Class Environmental Assessment from Lake Louise Drive/Worthington Avenue to 1.45 km West of Heritage Road, which I am sending on behalf of Mark Heaton.

Sincerely,

Jean Enneson  
Species at Risk Permits Biologist  
Aurora District  
Ontario Ministry of Natural Resources  
50 Bloomington Rd. W  
Aurora, ON  
L4G 0L8  
Tel: 905-713-6071  
Fax: 905-713-7361



Please consider the environment before printing this e-mail

Southern Region  
Aurora District Office  
50 Bloomington Road West  
Aurora, ON L4G 3G8

Nov 25, 2009

Hitesh Topiwala  
Project Manager, Project Planning and Studies  
Environment, Transportation and Planning Services  
Region of Peel  
9445 Airport Road, 3<sup>rd</sup> Floor,  
Brampton, ON L6S 4J3

**Re: Bovaird Drive Class Environmental Assessment from Lake Louise Drive/Worthington Avenue to 1.45 km west of Heritage Road**

Dear Mr. Topiwala,

We are in receipt of a Notice of Study Commencement for the above noted project. Please be advised that our review of your project relates to the *Endangered Species Act 2007*. This review does not eliminate the requirement to obtain any other permits or approvals for any legislation other than the *Endangered Species Act 2007*.

Your project has the potential to impact fisheries resources in Huttonville Creek. As you may know, Huttonville Creek supports the provincially endangered Redside Dace (*Clinostomas elongatus*), a small species of fish with a limited distribution in Canada. At the location of your project, Bovaird Drive crosses a reach of Huttonville Creek that is currently occupied by the species. The species and its habitat are protected under the *Endangered Species Act 2007*. The general habitat protection provision of Ontario's *Endangered Species Act* provides protection for areas on which the species depends, directly or indirectly, to carry on its life processes.

Please consult with MNR staff at this office to insure impacts to the species and its habitat resulting from your project are avoided. If impacts to the species and its habitat can not be avoided, a permit under section 17 of the *Endangered Species Act 2007* will be required.

If you have any questions or comments, please do not hesitate to contact me at 905-713-7406.

Sincerely,

*Mark Heaton*

Mark Heaton, Fish and Wildlife Biologist  
Aurora District

CC: Melinda Thompson-Black, Species at Risk Biologist





## Dearlove, Heather

---

**From:** Sinke, David  
**Sent:** Thursday, November 26, 2009 11:03 AM  
**To:** Slim, Barbara  
**Cc:** Dearlove, Heather  
**Subject:** FW: Class EA Bovaird Dr from Lake Louise Dr to 1.45km west of Heritage Road, Peel Region  
**Attachments:** Built & Cultural Heritage Checklist.doc; ArchaeologyPotentialOct09.doc

Barbara,  
Please see below.

David Sinke, B. Eng. Mgt., P. Eng.  
 Associate  
 Infrastructure Engineering  
 AMEC Earth and Environmental  
 3215 North Service Road  
 Box 220 Burlington ON L7N 3G2  
 905-335-2353 ext. 1234

[David.Sinke@amec.com](mailto:David.Sinke@amec.com)

Please update your records with my new email address. Thank you

---

**From:** Cifuentes, Alejandro (MCL) [mailto:Alejandro.Cifuentes@ontario.ca]  
**Sent:** Thursday, November 26, 2009 10:54 AM  
**To:** Sinke, David  
**Cc:** hitesh.topiwala@peelregion.ca  
**Subject:** Class EA Bovaird Dr from Lake Louise Dr to 1.45km west of Heritage Road, Peel Region

Dear Mr. Sinke,

Thank you for your letter with respect to the Class Environmental Assessment for the **Class EA Bovaird Dr from Lake Louise Dr to 1.45km west of Heritage Road, Peel Region**. From your letter, it is my understanding that the project is at an early stage within the Class EA process, however I would like to flag some important information that may or may not apply to this specific project:

As part of the Class Environmental Assessment process, the Ministry of Culture has an interest in the conservation of cultural heritage resources including:

- Archaeological resources;
- Built heritage resources; and
- Cultural heritage landscapes.

The Provincial Policy Statement, 2005 issued under the authority of the Planning Act defines "conserved" as "the identification, protection, use and/or management of cultural heritage and archaeological resources in such a way that their heritage values, attributes and integrity are retained. This may be addressed through a conservation plan or heritage impact assessment."

### Archaeology:

The site in question has archaeological potential for the following reasons... (Red = It applies to this project)

- a known archaeological site or within 250 meters of a known site
- within 300 meters of a primary water source (lakeshore, river, large creek)
- within 200 meters of a secondary water source (stream, spring, marsh, swamp)
- within 300 meters of an ancient water source (beach ridge, river bed)

- on elevated topography (knolls, drumlins, plateaux)
- on pockets of sandy soil in a clay or rocky area
- on unusual land formations (mounds, caverns, waterfalls)
- extractive area (for food or scarce resources)
- non-aboriginal settlement (monuments, cemeteries)
- historic transportation (road, rail, portage)
- designated property
- local knowledge
- recent disturbance (confirmed extensive and intensive = low potential)
- 

An archaeological assessment that conforms to the Ministry of Culture's *Standards and Guidelines for Consultant Archaeologists* is therefore required.

Or

The site has low archaeological potential and therefore does not require an archaeological assessment. If, however, deeply buried cultural remains (including human remains) are discovered during construction activities, this office should be notified immediately.

**Built Heritage / Cultural Heritage Landscapes:**

If the building/structure in question / site in question contains buildings/structures over 40 years old, a Heritage Impact Assessment should be undertaken. The Assessment should include the following:

1. Historical research, site analysis and evaluation
2. Identification of the significance and heritage attributes of the property
3. Description of the proposed development / site alteration
4. Measurement of impacts
5. Consideration of alternatives, mitigation and conservation methods
6. Implementation and monitoring schedules
7. Summary statement and conservation recommendations

For more information, refer to Ministry of Culture *InfoSheet #5: Heritage Impact Assessments and Conservation Plans* in the Ontario Heritage Tool Kit at [http://www.culture.gov.on.ca/english/heritage/Toolkit/Heritage\\_PPS\\_infoSheet.pdf](http://www.culture.gov.on.ca/english/heritage/Toolkit/Heritage_PPS_infoSheet.pdf)

The Heritage Impact Assessment should be sent to the local municipality and its Municipal Heritage Committee for their review and information as part of the Environmental Assessment process.

Please do not hesitate to contact me if you have any questions.

Best regards,

**Alejandro Cifuentes**

A/Heritage Planner  
 Ministry of Culture  
 Programs and Services Branch - Culture Services Unit  
 400 University Avenue, 4th Floor  
 Toronto, Ontario M7A 2R9  
 T 416-314-7159  
 F 416-212-1802  
[Alejandro.Cifuentes@ontario.ca](mailto:Alejandro.Cifuentes@ontario.ca)

**Ministry of Culture**  
**Criteria for Determining Archaeological Potential**

A Checklist for the Non-Specialist

Feature Of Archaeological Potential	Yes	No	Unknown
1. Known archaeological sites within 250 m?	<input type="checkbox"/>	<input type="checkbox"/>	<input type="checkbox"/>

Physical Features	Yes	No	Unknown
2. Is there water on or near the property? If Yes, what kind of water?	<input type="checkbox"/>	<input type="checkbox"/>	<input type="checkbox"/>
a) Primary water source within 300 m (lakeshore, river, large creek, etc)	<input type="checkbox"/>	<input type="checkbox"/>	<input type="checkbox"/>
b) Secondary water source within 200 m (stream, spring, marsh, swamp, etc)	<input type="checkbox"/>	<input type="checkbox"/>	<input type="checkbox"/>
c) Past water source within 300 m. (beach ridge, river bed, relic creek, etc)	<input type="checkbox"/>	<input type="checkbox"/>	<input type="checkbox"/>
3. Elevated topography (knolls, drumlins, eskers, plateaus, etc)	<input type="checkbox"/>	<input type="checkbox"/>	<input type="checkbox"/>
4. Pockets of sandy soil in a clay or rocky area	<input type="checkbox"/>	<input type="checkbox"/>	<input type="checkbox"/>
5. Distinctive land formations (mounds, caverns, waterfalls, peninsulas, etc)	<input type="checkbox"/>	<input type="checkbox"/>	<input type="checkbox"/>
6. Is there a known burial site or cemetery that is registered with the Cemeteries Regulation Unit directly adjacent to the property?	<input type="checkbox"/>	<input type="checkbox"/>	<input type="checkbox"/>

Cultural Features	Yes	No	Unknown
7. Associated with food or scarce resource harvest areas (traditional fishing locations, agricultural/ berry extraction areas, etc)	<input type="checkbox"/>	<input type="checkbox"/>	<input type="checkbox"/>
8. Indications of early Euro-Canadian settlement (monuments, cemeteries, structures, etc)	<input type="checkbox"/>	<input type="checkbox"/>	<input type="checkbox"/>
9. Associated with historic transportation routes (historic road, trail, portage, rail corridor, etc)	<input type="checkbox"/>	<input type="checkbox"/>	<input type="checkbox"/>

Property-specific Information	Yes	No	Unknown
10. Property is designated and/ or listed under the Ontario Heritage Act (municipal register)	<input type="checkbox"/>	<input type="checkbox"/>	<input type="checkbox"/>
11. Local knowledge (aboriginal communities, heritage organisations, etc)	<input type="checkbox"/>	<input type="checkbox"/>	<input type="checkbox"/>
12. Recent disturbance, not including agricultural cultivation (post-1960, extensive and intensive)	<input type="checkbox"/>	<input type="checkbox"/>	<input type="checkbox"/>

**Scoring the results:**

If **Yes** to any of **1, 2a-c, 6** or **11** → archaeological potential is **determined** – assessment is required

If **Yes** to two or more of **3 to 5** or **7-10** → archaeological potential is **determined** – assessment is required

If **Yes** to **12** or **No** to **1 to 10** → **Low** archaeological potential is **determined** – assessment may or may not be required (depending on answers from 1-11)

If 3 or more **Unknown** → more research required

### Screening for Impacts to Built Heritage and Cultural Heritage Landscapes

This check list will help identify potential cultural heritage resources, determine how important they are and indicate whether a cultural heritage impact assessment is needed.

Step 1 – Screening Potential Resources		
		<b>Built heritage resources</b>
<b>YES</b>	<b>NO</b>	Does the property contain any built structures, such as:
<input type="checkbox"/>	<input type="checkbox"/>	▪ Residential structures (e.g. house, apartment building, trap line shelter)
<input type="checkbox"/>	<input type="checkbox"/>	▪ Agricultural (e.g. barns, outbuildings, silos, windmills)
<input type="checkbox"/>	<input type="checkbox"/>	▪ Industrial (e.g. factories, complexes)
<input type="checkbox"/>	<input type="checkbox"/>	▪ Engineering works (e.g. bridges, roads, water/sewer systems)
		<b>Cultural heritage landscapes</b>
<b>YES</b>	<b>NO</b>	Does the property contain landscapes such as:
<input type="checkbox"/>	<input type="checkbox"/>	▪ Burial sites and/or cemeteries
<input type="checkbox"/>	<input type="checkbox"/>	▪ Parks
<input type="checkbox"/>	<input type="checkbox"/>	▪ Quarries or mining operations
<input type="checkbox"/>	<input type="checkbox"/>	▪ Canals
<input type="checkbox"/>	<input type="checkbox"/>	▪ Other human-made alterations to the natural landscape

Step 2 – Screening for Potential Significance		
		<b>A property's heritage significance may be identified through the following:</b>
<b>YES</b>	<b>NO</b>	1. Is it designated or adjacent to a property designated under the Ontario Heritage Act?
<input type="checkbox"/>	<input type="checkbox"/>	2. Is it listed on the municipal heritage register or provincial register (e.g. Ontario Heritage Bridge List)?
<input type="checkbox"/>	<input type="checkbox"/>	3. Is it within or adjacent to a Heritage Conservation District?
<input type="checkbox"/>	<input type="checkbox"/>	4. Does it have an Ontario Heritage Trust easement or is it adjacent to such a property?
<input type="checkbox"/>	<input type="checkbox"/>	5. Is there a provincial or federal plaque?
<input type="checkbox"/>	<input type="checkbox"/>	6. Is it a National Historic Site?
<input type="checkbox"/>	<input type="checkbox"/>	7. Does documentation exist to suggest built heritage or cultural heritage landscape potential? (eg. research studies, heritage impact assessment reports, etc.)
<input type="checkbox"/>	<input type="checkbox"/>	8. Was the municipality contacted regarding potential cultural heritage value? Were any concerns expressed?
<input type="checkbox"/>	<input type="checkbox"/>	9. What are the dates of construction? Are the buildings and/or structures over 40 years old? Is it within a Canadian Heritage River watershed?
<input type="checkbox"/>	<input type="checkbox"/>	10. Is a renowned architect or builder associated with the property?

Note: If you answer "yes" to any of the questions in Step 2, a heritage impact assessment is required.

<b>Step 3 – Screening for Potential Impacts</b>		
<b>YES</b>	<b>NO</b>	
<input type="checkbox"/>	<input type="checkbox"/>	<b>Destruction</b> of any, or part of any, significant heritage attribute or feature.
<input type="checkbox"/>	<input type="checkbox"/>	<b>Alteration</b> that is not sympathetic, or is incompatible, with the historic fabric or appearance.
<input type="checkbox"/>	<input type="checkbox"/>	<b>Shadows</b> created that alter the appearance of a heritage attribute or change the visibility of a natural feature or plantings, such as a garden.
<input type="checkbox"/>	<input type="checkbox"/>	<b>Isolation</b> of a heritage attribute from its surrounding environment, context or a significant relationship.
<input type="checkbox"/>	<input type="checkbox"/>	<b>Direct or indirect obstruction</b> of significant views or vistas from, within, or to a built and natural feature.
<input type="checkbox"/>	<input type="checkbox"/>	<b>A change in land use</b> such as rezoning a battlefield from open space to residential use, allowing new development or site alteration to fill in the formerly open spaces.
<input type="checkbox"/>	<input type="checkbox"/>	<b>Land disturbances</b> such as a change in grade that alters soils and drainage patterns that adversely affect an archaeological resource.

### Contents of a Heritage Impact Assessment

As a minimum, the following should be included in a heritage impact assessment:

1. Historical research, site analysis and evaluation
2. Identification of the significance and heritage attributes of the property
3. Description of the proposed development/ site alteration
4. Measurement of impacts
5. Consideration of alternatives, mitigation and conservation methods
6. Implementation and monitoring schedules
7. Summary statement and conservation recommendations

For more information, refer to Ministry of Culture *Info Sheet#5: Heritage Impact Assessments and Conservation Plans* as part of the Ontario Heritage Tool Kit, which is available on the Ministry's website [www.culture.gov.on.ca](http://www.culture.gov.on.ca) .



✓✓

**Dearlove, Heather**

---

**Subject:** FW: Initial Comments - Bovaird Drive EA Study

**From:** Parajuli, Bishnu [mailto:Bishnu.Parajuli@brampton.ca]  
**Sent:** Tuesday, December 15, 2009 9:07 AM  
**To:** Hitesh.Topiwala@peelregion.ca  
**Cc:** Sinke, David; Tunio, Khurram; Duyvestyn, Chris  
**Subject:** Initial Comments - Bovaird Drive EA Study

Re: Initial Comments - Bovaird Drive Environmental Assessment Study from Lake Louise / Worthington Avenue to 1.45 km West of Heritage Road

City File: N0109-3215-111

Hi Hitesh,

Thank you for informing the City of Brampton about the initiation of the aforementioned Environmental Assessment Study. The City provides the following initial comments for your consideration.

- Please consider the provision of access to the City property, 2719 Bovaird Drive West, for future expansion of the facility. The City also wants to explore an opportunity to get water service extended along Bovaird as part of this project. This would allow for service to the City property, 2719 Bovaird Drive West.
- Please assess trucking impacts on Bovaird Drive in light of the proposed shale extraction site northeast of Norval.
- The Pathways master plan identifies a 3.0 m multiuse trail along Bovaird Drive. At present, the multiuse trail is on the north side of Bovaird Dr, East of Chinguacousy Rd. Preference would be to continue on the north side.
- Please incorporate an enhanced entrance into the Mount Pleasant GO Station with appropriate pedestrian sidewalk connections into the station from the street and a well delineated and enhanced pedestrian crossing to the new residential area on the south side of Bovaird Drive.
- Please coordinate with the Strybos Barron King Landscape Architect (tel. 416-685-4949) about the proposed gateway feature at the intersection of James Potter Rd and Bovaird Drive and other landscape features in the Spring Valley area. City contact for landscaping issues is John Allison ([john.allison@brampton.ca](mailto:john.allison@brampton.ca) or 905 874 3880)
- The Street Corridor Master Plan identifies the intersection of Mississauga Road and Bovaird Drive as a Primary Gateway. This area falls partly within Mount Pleasant Secondary Plan area. For specific information on Mount Pleasant Secondary Plan, please contact Neal Grady at 905-874-2064 or [neal.grady@brampton.ca](mailto:neal.grady@brampton.ca). For information on development west of Mississauga Road, please contact David Waters at 905-874-2074 or [david.waters@brampton.ca](mailto:david.waters@brampton.ca).
- There is a future park planned for the southeast corner of Mississauga Road and Bovaird Drive. However, there has been some talk in the past with the Peel Region District School Board about flipping sites so that the school is at the southeast corner of Mississauga Road and Bovaird Drive and the park is adjacent to the south. Now that the respective plans in this area of CVSP Blocks 1 & 3 are beginning to advance, further talks may resume.
- The scope of the study extends across the Credit River into Norval. A satisfactory bridge structure and preservation and restoration at the river crossing should be identified.
- Brampton Transit currently operates a number of services within the study area, primarily to and from the Mount Pleasant GO Station across the Bovaird Drive Corridor and through the adjacent residential areas to the east and south. In the future, transit services are planned to extend to the west along the Bovaird Drive corridor, including

a future planned Bus Rapid Transit corridor along Bovaird Drive to Mississauga Road. As such, we would like the opportunity to review and comment on the preliminary preferred design from a transit planning perspective.

- Please forward us the following draft materials and allow reasonable time for our review and comments prior to presenting to the public.
  - PIC materials.
  - Preliminary design drawings before and after PIC meetings.
  - Two hard copies of Draft ESR including appendices for review prior to filing. Final ESR including appendices in hardcopy and in CD.
  - Any other report/materials that may identify impact to the City's interests.
  
- I will be the primary contact from the City of Brampton for technical matters and will be co-ordinating comments from other City Departments. However, please maintain direct contact with Councillors, Mayor, Emergency Services (Police, Fire, Ambulance etc.), Boards/Commissions/Committees and others from the City/Region as required under EA consultation. Please add me in your project mailing list as well as in the invitation list of regular Technical Steering / Agencies Committee meetings and send us invitations for dry-run PICs / project team meeting(s) prior to PICs. Based on meeting agenda and outstanding issues at the time of invitation, we will also forward the invitation to other appropriate City staff to attend these meetings. If there are no technical meetings scheduled, we suggest that Region set-up separate meetings with City staff prior to PIC and finalizing design.

Should you have any questions, please do not hesitate to contact me.

Thank you,

Bishnu Parajuli, P. Eng.  
Project Engineer  
Engineering & Construction Division  
Works & Transportation Department  
City of Brampton  
8850 McLaughlin Road, Unit 2, Brampton, ON. L6Y 5T1  
Tel: (905) 874 3644, Fax: (905) 874 2599  
Email: [bishnu.parajuli@brampton.ca](mailto:bishnu.parajuli@brampton.ca)

The content of this email message should be treated as confidential and is the property of The Corporation of the City of Brampton. This email message is for the sole use of the intended recipient and may not be copied, modified, distributed, or used without the express permission of the sender. If you are not the intended recipient, please destroy all copies of this email and notify the sender immediately. Information related to this email is automatically monitored and recorded and the content may be required to be disclosed by the City to a third party in certain circumstances.

Personal information is collected and protected under the authority of the Municipal Freedom of Information and Protection of Privacy Act, R.S.O. 1990, c. M-56.

If you have any questions regarding the City's application of this Act please contact the City's Freedom of Information and Protection of Privacy Co-ordinator at 905-874-2118 or [cityclerksoffice@brampton.ca](mailto:cityclerksoffice@brampton.ca).



109089-12  
JJ

**Dearlove, Heather**

---

**Subject:** FW: Lake Louise Drive - EG 72550

**From:** Diana Beaulne [mailto:Diana.Beaulne@enbridge.com]  
**Sent:** November 3, 2009 12:23 PM  
**To:** Topiwala, Hitesh  
**Subject:** Lake Louise Drive - EG 72550

Re ; Environmental Assessment,

Thank you for your letter informing us of your future planned work. Enbridge has buried plant in numerous locations throughout your planned work area. Currently the scope of your project is too general to determine if a conflict exists. During the engineering design of your project please send us copies of your plans per normal procedure so we may review.

Regards,

Diana Beaulne  
Markup Administrator  
Enbridge Gas Distribution Inc.  
500 Consumers Rd  
4th, Floor, Post A2, VPC  
North York, Ontario  
M2J 1P8

Tel: 416-495-5160  
FAx: 416-758-4373

[markups@enbridge.com](mailto:markups@enbridge.com)  
[utilitycirculations@enbridge.com](mailto:utilitycirculations@enbridge.com)

The information transmitted is intended only for the addressee and may contain confidential, proprietary and/or privileged material. Any unauthorized review, distribution or other use of or the taking of any action in reliance upon this information is prohibited. If you receive this in error, please contact the sender and delete or destroy this message and any copies. Note all markups are valid for 6 months from date of receipt.

The attached file(s) are for reference purposes only. It is the responsibility of the parties receiving this information to verify it's accuracy and correctness. ENBRIDGE GAS DISTRIBUTION is not responsible for modified or reproduced versions of the data being transferred. These files are not stamped and sealed and should not be treated as such.

November 3, 2009  
Project No. 09-4360

Ms. Joyce Hutton  
10388 Heritage Road  
Brampton, ON L7A 0E7

**Re: Class Environmental Assessment  
Bovaird Drive West from Lake Louise Drive/Worthington Avenue to 1.45 km  
west of Heritage Road, Brampton**

---

Dear Ms. Hutton:

Thank you for returning comments to the above Environmental Assessment (EA) Notice of Commencement. Your comments will become part of the official EA record.

The purpose of the study is to:

- review current and future levels of service on Bovaird Drive with consideration for existing and future growth and development along the corridor;
- identify problems and opportunities for improvements; and
- recommend a solution through a comprehensive and environmentally sound planning process, with public participation.

Two public meetings will be held as part of the EA consultation. The first Public Information Centre (PIC#1) will be held in the first quarter of next year (2010), and will consist of an informal drop-in centre with display information on the study findings to date including the problem statement, planning alternatives and evaluation of the planning alternatives. Existing traffic issues will also be identified at this time.

We welcome your participation in the study and details regarding the forthcoming PIC will be sent to you when available. If you have further questions, please contact me.

Yours sincerely,



Hitesh Topiwala, Project Manager  
Project Planning & Studies  
Transportation Division  
Public Works  
hitesh.topiwala@peelregion.ca  
905-791-7800 x7805  
Fax: 905-791-1442

/lb

Copy: David Sinke, AMEC Phillips  
Councillor John Hutton, City of Brampton

---

**Environment, Transportation and Planning Services**

9445 Airport Rd., 3rd Floor, Brampton, ON L6S 4J3  
Tel: 905-791-7800 www.peelregion.ca

109089-12.  
✓✓

**Dearlove, Heather**

---

**Subject:** FW: My comments; Bovaird Dr

---

**From:** [mailto:info@pit-stop.ca]  
**Sent:** November 6, 2009 7:37 PM  
**To:** Topiwala, Hitesh  
**Cc:** 'Mary Churchill'; kgastle@norvalontario.com  
**Subject:** My comments; Bovaird Dr

My Comments, re. Bovaird Dr. EA

Bovaird Dr. leads to a bottle neck in Norval, and the highway in Norval will never be widened. The E.W. boundary connection must bypass Norval.

The Norval village and surrounding valley lands have special natural, cultural and historical qualities that must be preserved. This includes the tributary and valley that bisects Brampton Brick's proposed Norval Quarry, east off Winston Churchill, one lot north of Bovaird Dr..

I would be a dark legacy if widening Bovaird helped to make it permissible for Brampton Brick to have a quarry and a truck route through the north east corner of Norval.

Norval pit-STOP Community Organization

109089-12  
✓✓

**Dearlove, Heather**

---

**From:** Topiwala, Hitesh [Hitesh.Topiwala@peelregion.ca]  
**Sent:** Sunday, November 15, 2009 2:21 PM  
**To:** Sinke, David  
**Cc:** Dearlove, Heather  
**Subject:** Notice of commencement

Hello David,

I recieved a phone call from a resident saying she did not recieve the notice of commencement for our Bovaird Drive EA.

Here is the contact information:

Please review our mailing list and send her a second package. She mentioned that Canada post does not deliver her mails so please have it couriered to her.

Thanks,

Hitesh

-sent via courier  
Nov 16/09.

109089-12  
VV

**Dearlove, Heather**

---

**From:** Sinke, David  
**Sent:** Wednesday, November 18, 2009 7:35 AM  
**To:** Dearlove, Heather  
**Subject:** FW: Bovaird Drive Class Environmental Assessment

David Sinke, B. Eng. Mgt., P. Eng.  
Associate  
Infrastructure Engineering  
AMEC Earth and Environmental  
3215 North Service Road  
Box 220 Burlington ON L7N 3G2  
905-335-2353 ext. 1234

[David.Sinke@amec.com](mailto:David.Sinke@amec.com)

Please update your records with my new email address. Thank you

**From:** Topiwala, Hitesh [mailto:Hitesh.Topiwala@peelregion.ca]  
**Sent:** Wednesday, November 18, 2009 1:16 AM  
**To:** T  
**Cc:** Sinke, David; Brock, Liz  
**Subject:** RE: Bovaird Drive Class Environmental Assessment

Hello Jc

Thank you for your email and interest in the Bovaird Drive EA.

Your names will be added to our contact list for any future communications about this project.

If you have any questions or concerns, please contact me.

Thanks,

Hitesh

---

**From:**  
**Sent:** November 17, 2009 7:04 PM  
**To:** Topiwala, Hitesh  
**Subject:** Bovaird Drive Class Environmental Assessment

We have received the notification of the commencement of the above EA. As a landowner in the area with an interest in the process and potential impacts on our property, we would appreciate being added to any e-mail and/or mailing list to be kept informed of the progress of the project or meetings schedule.

E-mail notifications may be sent to [terryfamily@sympatico.ca](mailto:terryfamily@sympatico.ca) and mailings may be sent to 10044 Heritage Road, Brampton, L7A 0E7

Thank you.