

February 25, 2019
Project 13-1347 B

**NOTIFICATION OF 24-HOUR TUNNELLING WORK
UNDER THE QEW AND ALONG BENEDET DRIVE
FROM SOUTH SHERIDAN WAY TO POPLAR CRESCENT
CITY OF MISSISSAUGA**

What are we doing?

- Installing two watermains in a tunnel under the QEW and one watermain in a tunnel along Benedet Drive from South Sheridan Way to Poplar Crescent.

When?

- 24-hour tunnelling will begin on March 4, 2019 and is anticipated to be completed in approximately 10 weeks.
- Tunnelling will be carried out continuously, 24 hours per day, from 7 am Monday mornings to 2 pm Saturday afternoons.
- No tunnelling will occur on Sundays.

Why continuously for 24 hours Monday to Saturday?

- Continuous tunnelling operations will minimize the inconvenience to local residents and businesses by shortening the overall construction schedule.

What does this mean for you?

- We do not anticipate significant additional noise or vibration above normal daytime levels during the 24 hours per day tunnelling operations.
- Efforts have been made to reduce impacts to local residents such as: wood hoarding with sound insulation installed around the site, restricting material deliveries and removals by truck to daytime hours.
- Vibration monitoring instruments and ground survey points have been installed along the tunnelling route in order to monitor any vibrations or ground movement.

We appreciate your co-operation during the completion of this work and apologize in advance for any inconvenience.

If you have any questions, please call me at 905-791-7800 x 7832 or email me at nicole.sartor@peelregion.ca.

Thank you!

Nicole Sartor
Project Manager – Water Division
Public Works
Region of Peel

C: Councillor K. Ras



LEGEND

LIMIT OF TUNNELLING



WATERMAIN CONSTRUCTION ON SPEAKMAN DRIVE, FLAVELLE BLVD, NORTH SHERIDAN WAY CITY OF MISSISSAUGA

PROJECT MANAGER: NICOLE SARTOR (905) 791-7800 X7832
COUNCILLOR: KAREN RAS (WARD 2)

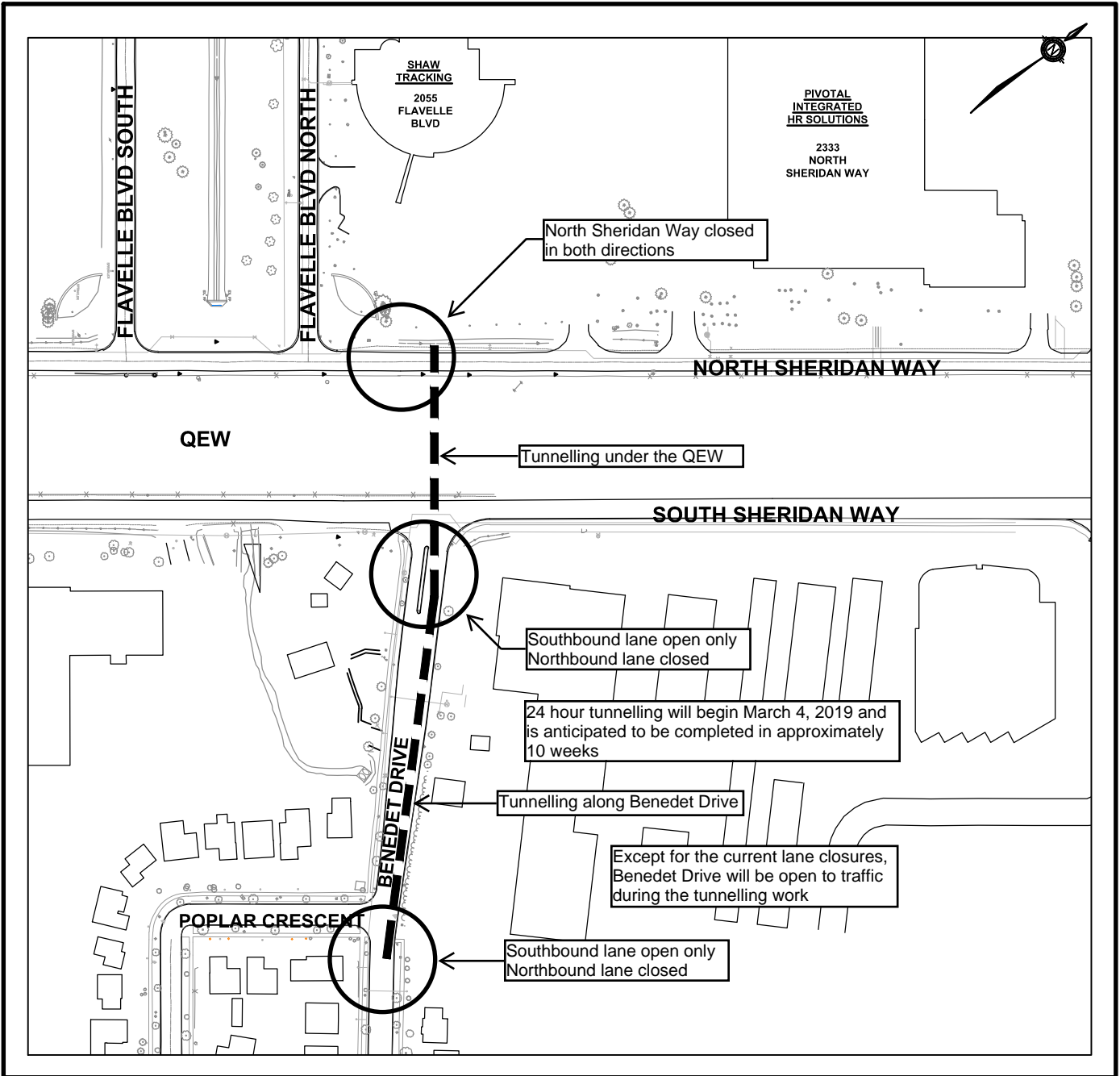

PUBLIC WORKS

10 PEEL CENTRE DRIVE - SUITE B, 4TH FLOOR, BRAMPTON ON L6T 4B9 (905) 791-7800